

SIZE	ØA	B
1	2.50	1.87
1-1/2	3.25	1.87
2	4.00	1.87
2-1/2	4.75	1.87
3	5.25	1.87
4	6.75	2.12
6	8.62	2.25
8	10.87	2.25

MODULE SEAL W/INTERNAL  
SNUBBER/PULSATION DAMPNER.

SENSOR FITS INSIDE BOLT PATTERN OF  
MATING FLANGES

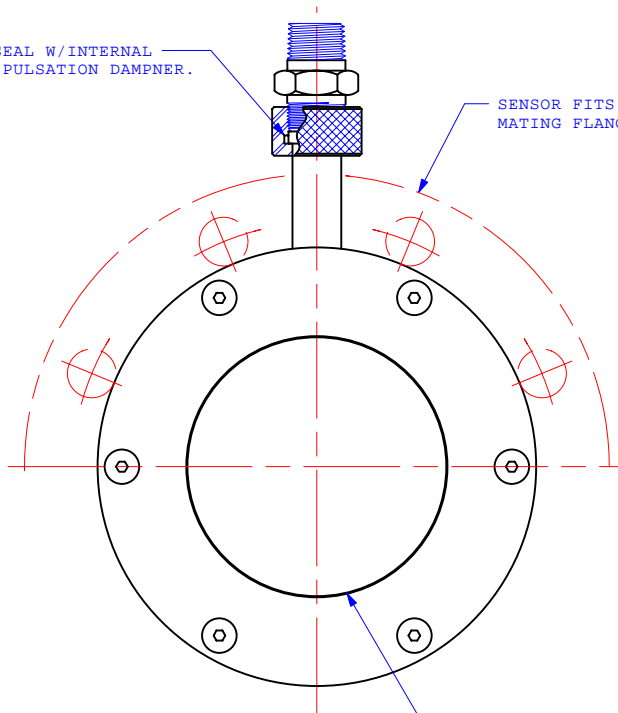

TUBE I.D. MATCHES SCH. 40  
CARBON STEEL PIPE

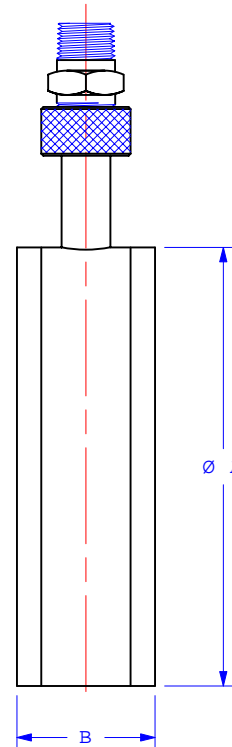

CENTER MATERIAL:

- CARBON STEEL
- 316 STAINLESS STEEL
- CARPENTER 20 STAINLESS STEEL
- OTHER \_\_\_\_\_

END PLATE MATERIAL:

- ACETAL
- 316 STAINLESS STEEL
- CARPENTER 20 STAINLESS STEEL
- TEFLON
- OTHER \_\_\_\_\_

SLEEVE ELASTOMER:

\_\_\_\_\_

FITTINGS & MODULE SEAL MATERIAL:

- CARBON STEEL/BRASS
- CARBON STEEL/316 S.S.
- 316 S.S./316 S.S.
- 316 S.S./BRASS
- OTHER \_\_\_\_\_

FILL FLUID:

- SILICONE (STD) (-40° F TO 400° F)
- FDA SILICONE (-20° F TO 400° F)
- OTHER \_\_\_\_\_

PRESSURE RATING:

1,000 PSI MAXIMUM

ALL DIMENSIONS ARE IN INCHES.

CUSTOMER
FOR
CUSTOMER NO.
ITEM
ORDER/ER

REV	DESCRIPTION	BY	DATE	APP'D
<b>ONYX VALVE</b>				
TITLE : PRESSURE SENSOR				
SCALE : NONE		DRAWN : RJD	DATE	
ORDER/ER :		CHE'D.	DATE	
CUSTOMER :		APP'D.	DATE	
	CODE	ENG NO.	SHT. 1	REV.
			OF 1	